



WAL20 PRO

HEAVY-DUTY PEDESTRIAN LI-ION PALLET TRUCK 2.0T

 2000 kg  125 mm  24 V Li-Ion



Ideal for warehouses, retail logistics, manufacturing, and last-mile distribution, the WAL 20 PRO thrives in narrow aisles, containers, and high-density storage zones. Its ultra-compact chassis (435 mm length) and tight 1,283 mm turning radius make it the perfect solution for operations with limited maneuvering space. Highly performing in both travel and lifting speeds, the WAL 20 PRO ensures reliable, quiet, and safe material handling across shifts.

SPECIFICATION	REF	UNIT	VALUE
Battery type			Li-Ion
Battery nominal capacity K5		Ah	100
Battery voltage		V	24
Rated capacity	Q	kg	2000
Load centre distance	c	mm	600
Service weight		kg	350
Lift	h ₃	mm	125
Overall length		mm	1585
Overall width	b ₁ /b ₂	mm	720
Length to face of forks	l ₂	mm	435
Fork dimensions	s/e/l	mm	55/170/1150
Turning radius		Wa	1283
Manufacturer			EP
Model designation			WAL20 PRO
Drive			Electric
Operator type			Pedestrian

Features

Ultra-Compact Chassis and Tight Turning Radius

With a class-leading 435 mm chassis length and 1,283 mm turning radius, the WAL 20 PRO operates effortlessly in narrow aisles, trailers, and confined spaces. This compact build enhances maneuverability and reduces storage and transport costs.



Maximum traction and stability with low noise emission

Thanks to the innovative synchronized castor system WAL PRO maintains great balance and traction even under heavy loads and on every kind of floor. Operating noise remains below 65 dB, ensuring smooth, quiet, and safe handling in all warehouse conditions.

Advanced Lithium Technology with Integrated Charger

Equipped with a 24 V / 100 Ah Li-ion battery and 30 A integrated charger, the WAL PRO offers long runtime and enables opportunity charging during breaks for maximum uptime. The optional 205 Ah battery and 100 A external charger support intensive multi-shift operations.

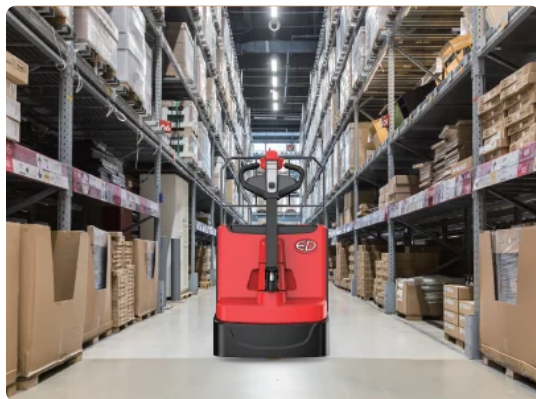

High-Performance AC

A 2.2 kW pump motor and 1.6 kW AC drive motor deliver fast travel, lifting, and lowering speeds. With strong gradeability and responsive control, the truck performs reliably in heavy-duty warehouse and logistics applications.

Operator-Focused Digital Features

The multi-function color display shows battery level, speed, status, and time; the ESP drive mode selector adapts performance to operator preferences. Optional operator ID (PIN or card) and Bluetooth app connectivity enhance safety and simplify maintenance.



VDI Chart

	SPECIFICATION	REF	UNIT	VALUE
1.1	Manufacturer			EP
1.2	Model designation			WAL20 PRO
1.3	Drive			Electric
1.4	Operator type			Pedestrian
1.5	Rated capacity	Q	kg	2000
1.6	Load centre distance	c	mm	600
1.8	Load distance, centre of drive axle to fork		mm	980
1.9	Wheelbase		mm	1257
2.1	Service weight		kg	350
2.2	Axle loading, laden front/rear		kg	930/1420
2.3	Axle loading, unladen front/rear		kg	280/70
3.1	Tyres			PU
3.2	Tyre size, front		mm	Φ230 x 75
3.3	Tyre size, rear		mm	Φ80x85
3.4	Additional wheels (castor wheels)		mm	Φ74x30
3.5	Wheels, number front/rear (x=drive wheels)			1/2/4
3.6	Tread width, front	b ₁₀	mm	500
3.7	Tread width, rear	b ₁₁	mm	370/515
4.4	Lift	h ₃	mm	125
4.9	Height drawbar in driving position min./max.			900/1230
4.15	Height, lowered			85
4.19	Overall length		mm	1585
4.20	Length to face of forks	l ₂	mm	435
4.21	Overall width	b ₁ /b ₂	mm	720

	SPECIFICATION	REF	UNIT	VALUE
4.22	Fork dimensions	s/e/1	mm	55/170/1150
4.25	Distance between fork-arms			540/685
4.32	Ground clearance, centre of wheelbase		mm	27
4.34.1	Aisle width for pallets 1000×1200 crossways		Ast	2083
4.34.2	Aisle width for pallets 800 × 1200 lengthways		Ast	1883
4.35	Turning radius		Wa	1283
5.1	Travel speed, laden/unladen		km/h	6/6
5.2	Lift speed, laden/unladen		m/s	0.065/0.078
5.3	Lowering speed, laden/unladen		m/s	0.04/0.04
5.8	Max. gradeability, laden/unladen		%	10/20
5.10	Service brake			Electromagnetic
6.1	Drive motor rating S2 60 min		kW	1.6
6.2	Lift motor rating at S3 15%		kW	2.2
6.4	Battery nominal capacity K5		Ah	100
6.4	Battery voltage		V	24
6.4.1	Battery type			Li-Ion
6.5	Battery weight		kg	44
6.6	Energy consumption according to DIN EN 16796		kWh/h	0.256
6.7	Turnover output according to VDI 2198			85.16
6.8	Turnover efficiency according to VDI 2198			171.35
8.1	Type of drive unit			AC
10.5	Steering design			Mechanical
10.7	Sound pressure level at the driver's seat		dB(A)	65

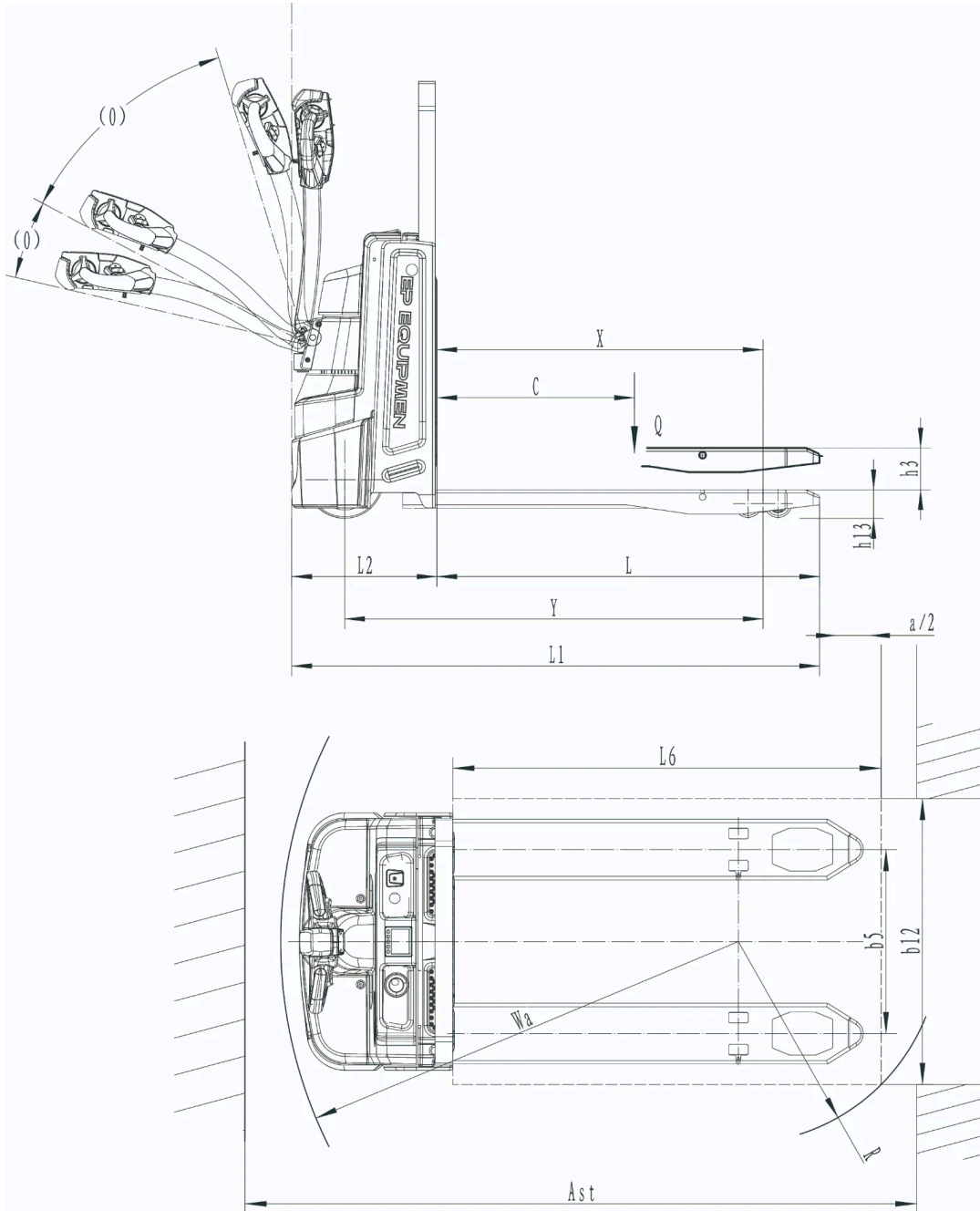

Options

ITEM	OPTIONS (optional items marked in yellow)
Fork dimension	540*1150 540*850 540*1000 540*1220 540*1300 540*1450 540*1600 540*1800 540*2000 540*2400 685*850 685*1000 685*1150 685*1220 685*1300 685*450 685*1600 685*1800 685*2000 685*2400
Fork lowered height	85
Backrest height	no 1220 1520

ITEM	OPTIONS (optional items marked in yellow)
Load wheel type	double single
Load wheel material	PU
Drive wheel material	PU Trace PU
Battery capacity	100Ah (Li-ion) 205Ah (Li-ion)
Charger	24V-30A Integrated 24V-100A External
Battery display indicator (BDI)	With hourmeter
Traction pin	no Yes and not customized
Castor wheels	Yes and not customized
Vertical handler working	Yes and not customized
Telematics	Yes and not customized No
Drive cover off the ground	35mm